

Inquiry Order

Customer number: _____

Company stamp / address:

Contact person: _____

Telephone: _____

Quotation No.: _____

Commission: _____

with rungs*



Number of rungs: _____ pieces

Number of systems: _____ Corner angles 90°: _____ pieces Number of panels: _____

Dimensions: Width: _____ (total unfolding) Height: _____ (incl. possible floor recession)

Colour: RAL _____ E6-EV1 DB703 DB703FS Special colour: _____

Pre anodizing

Glazing: 10 mm toughened glass, clear with Heat-Soak-Test Special glass: _____

Type: (Attention: Inside view, other panel partitions available (max. of 6 panels in one direction possible))

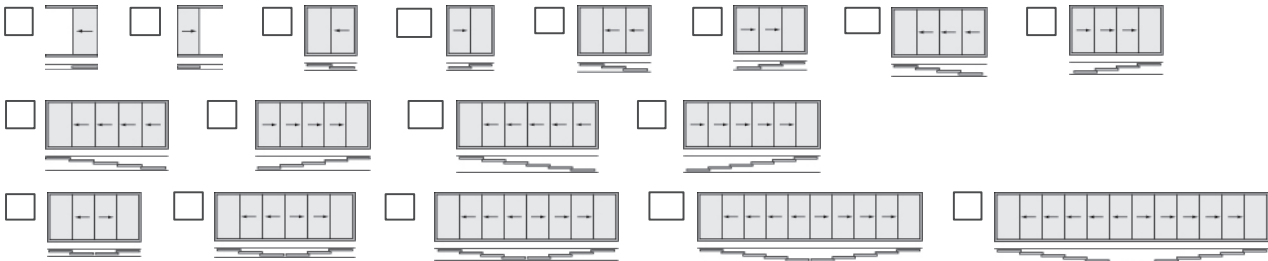

Bottom rail: with optimally shortened running edges (Standard) with continuous running edges

Mounting profile (E6-EV1): without with (only pos. with att. bottom rail, height incl. mounting profile) in system color

Rail extension:

right length L _____ mm
 left length L _____ mm

Typ:
 EV1

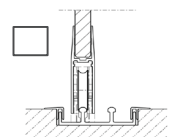
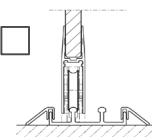
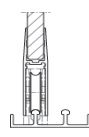
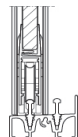

Outdoor use (2-6 tracks)



Indoor use (1-6 tracks)

Lateral wall connection: without Lateral frame Brush gaskets at the panel

Running assembly: single-sided double-sided without



Coated: Carriage Handle Locking operating lever

Handle left:

  *
  *
 Height of knob = _____ (indicate knob height from lower edge of panel profile)



* in system color

Handle right:

  *
  *
 Height of knob = _____ (indicate knob height from lower edge of panel profile)

* in system color

Handle center:

  *
  *
 Height of knob = _____ (indicate knob height from lower edge of panel profile)

left
 right
 * in system color

Locking left: (only with vertical frame!)

 
 with lock
 Height locking = _____ (indicate knob height from lower edge of panel profile)

fix locking

inside
 outside

Locking right: (only with vertical frame!)

 
 with lock
 Height locking = _____ (indicate knob height from lower edge of panel profile)

fix locking

inside
 outside

Locking center:

 with lock
 Height locking = _____ (indicate knob height from lower edge of panel profile)

inside
 outside

Please enclose floor plan resp. view sketch and remarks (please use inside view)